

NH Dimension Bladed Style 1000V: 32-630A



Description

Chordn APJ series NH size photovoltaic fuse links are specifically designed to protect and isolate photovoltaic array combiners and disconnects. These fuse links are capable of interrupting low overcurrents associated with faulted PV systems (reverse current, multi-array fault).

Ratings

Volts: 1000VDC
Amps: 32 - 630A
I.R. DC: 30KA
Time constant: 1-3ms
Speed/Characteristic: gPV
Material Body: Ceramic
Caps: Copper Alloy (Silver Plated)
Environmental RoHS Compliant

Standards

IEC 60269-6

Features and Benefits

Low fault current interrupting capability
Durable construction for enhanced system longevity
High efficiency with low power losses
Small footprint
Indicator feature

Typical Applications

All photovoltaic applications
PV string/array level protection
Combiner box applications
In-line PV module protection
Inverters
Battery charge controllers

NH Dimension Bladed Style 1000V: 32-630A

Catalog Numbers

Electrical Characteristics				Ordering Information		Dimensions
Size	Rated current	Clearing I ² t @ rated voltage (A ² s)	Watts Loss	Part number	Carton qty	Figure number
01	32	800	9W	APJ01-32A	3	Fig.1
	40	1800	10W	APJ01-40A		
	50	3600	11W	APJ01-50A		
	63	4203	12W	APJ01-63A		
	80	5742	15.5W	APJ01-80A		
	100	11700	16.5W	APJ01-100A		
	125	22923	17.5W	APJ01-125A		
	160	46782	22W	APJ01-160A		
	175	75000	25W	APJ01-175A		
	200	83000	29W	APJ01-200A		
02	160	38000	28W	APJ02-160A	1	Fig.1
	200	77000	32W	APJ02-200A		
	250	100000	40W	APJ02-250A		
	315	155000	50W	APJ02-315A		
03	300	135000	45W	APJ03-300A	1	Fig.1
	315	140000	48W	APJ03-315A		
	350	160000	52W	APJ03-350A		
	400	230000	55W	APJ03-400A		
	500	251200	70W	APJ03-500A		
	630	270000	85W	APJ03-630A		

Dimensions(mm)

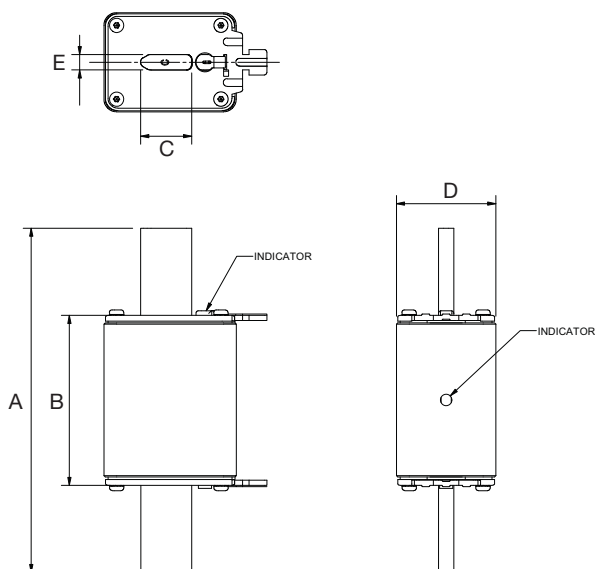

Size	Amp	A	B	C	D	E
01	32-200A	135	75	20	46	6
02	160-315A	150	75	25	58	6
03	300-630A	150	75	32	69	6

1mm = 0.0394" / 1" = 25.4mm

Fig.1

NH Dimension Bladed Style 1000V: 32-630A

APJ01 32-200A: 1000V

Time-Current Curve

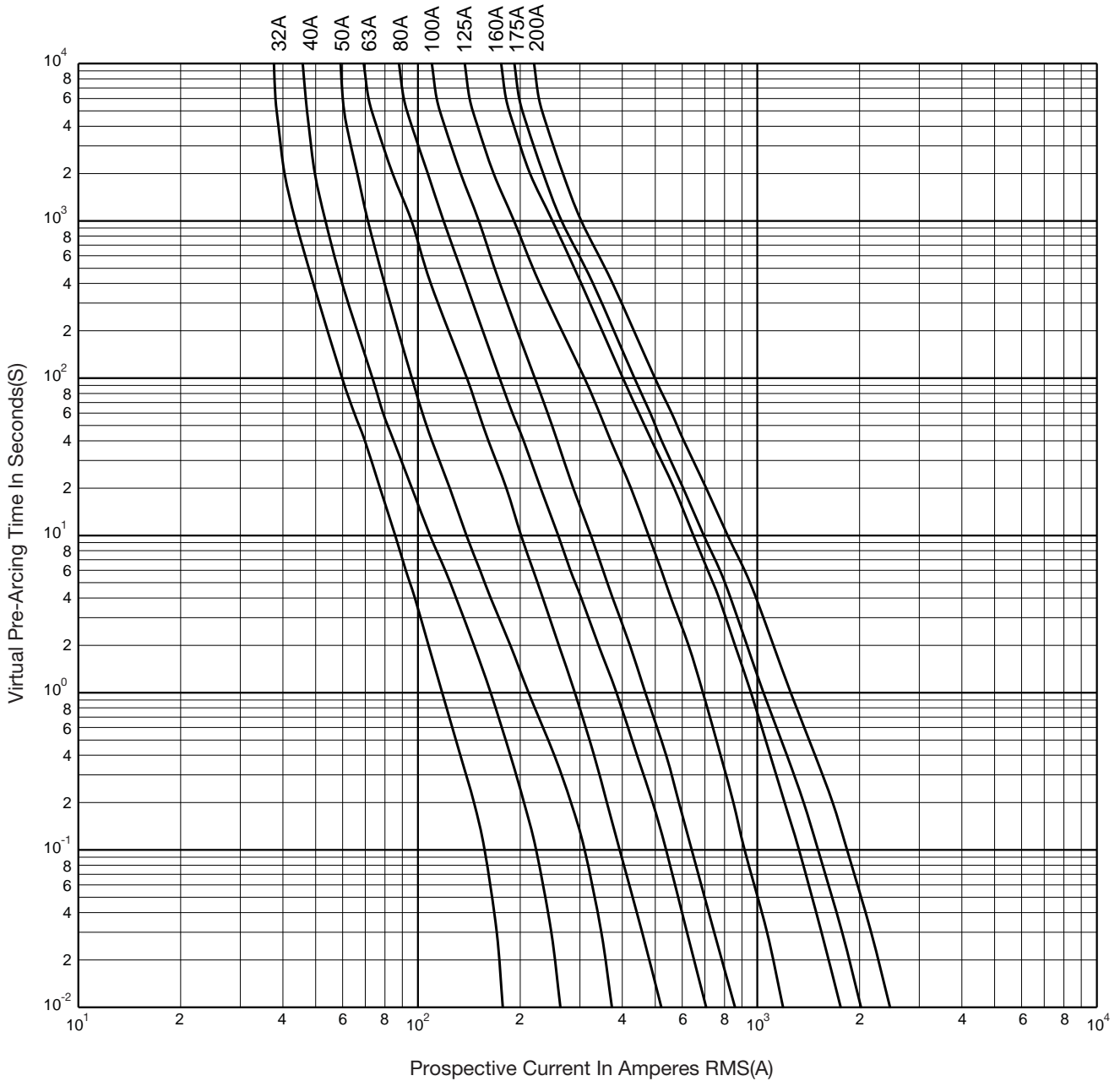

NH Dimension Bladed Style 1000V: 32-630A

APJ02 160-315A: 1000V

Time-Current Curve

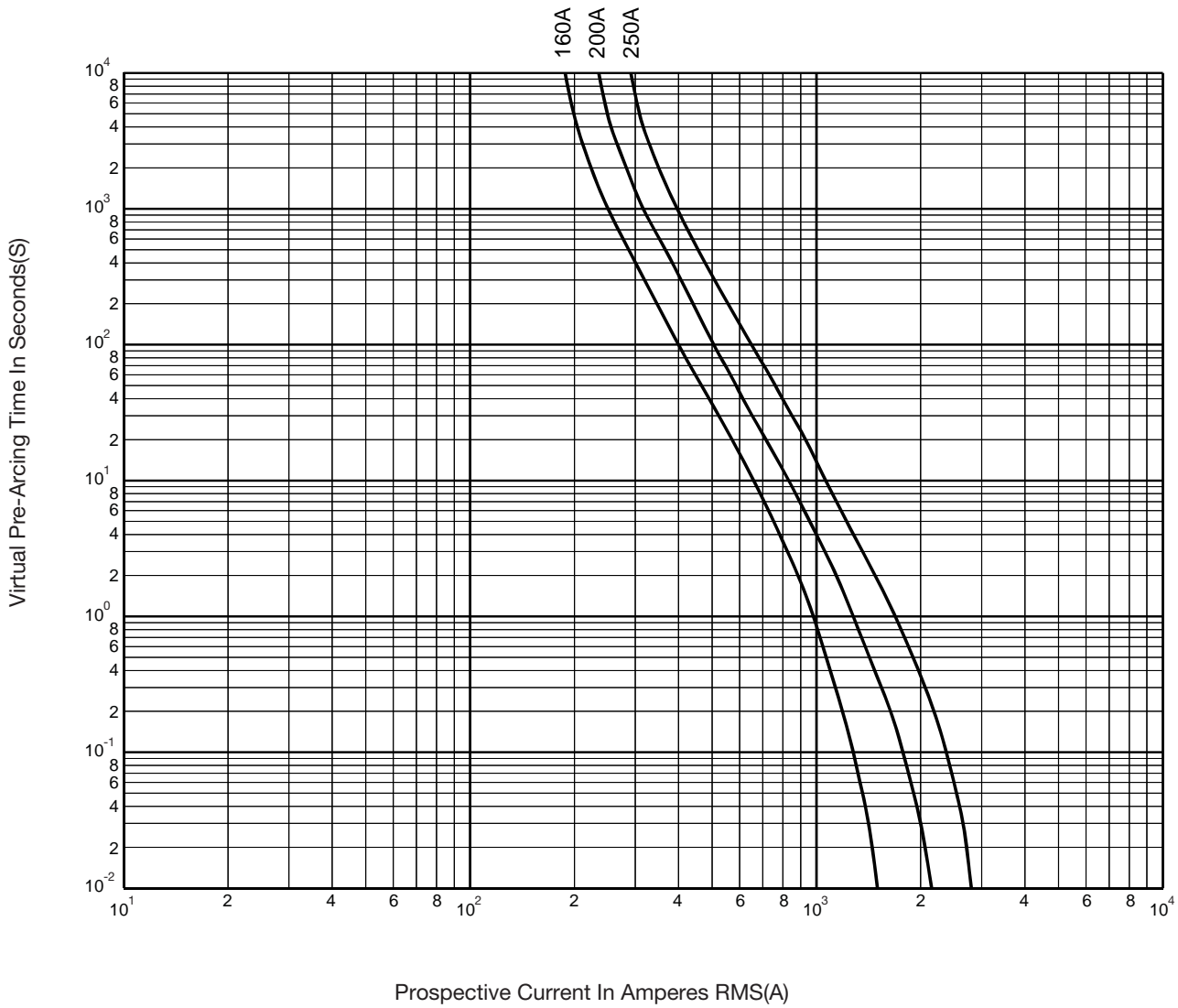

NH Dimension Bladed Style 1000V: 32-630A

APJ03 300-630A: 1000V

Time-Current Curve

