



## Description

A dedicated smoke detectors for electrical cabinet is a device that senses smoke, typically as an indicator of fire, and issues sound and light alarm signal in time. Using CPU control, it can intelligently detect the smoke concentration of fire. When the smoke concentration exceeds the preset alarm threshold, the detector will be triggered into the alarm state and the relay gives response at the same time. The alarm signal will be presented in the form of changeable action of the relay contacts and has the alarm locking function. Resetting the alarm can only be done through a short power off. In addition, chordn smoke detector is fitted with relay output and RS485 communication. It's particularly suitable for those scene where the fire is likely to generate a large amount of smoke but no smoke under normal situation, such as computer rooms, communications machine rooms, power distribution cabinets and so on.

## Feature

- Power supply: 9-30VDC
- Relay output or RS485
- Smoke temperature monitoring
- Red indicator light flashing monitoring
- High precision and reliability
- Detection of up to 60m<sup>2</sup>
- Acoustic alarm > 80dB
- Modbus RTU RS485 serial communication port(Optional)
- Red LED (short flash once every 6 sec(alive signal), The smoke detector is OK

## Application

- Restaurants, hotels
- Teaching buildings, office buildings
- Computer rooms, communications machine rooms, power distribution cabinets



## Technical data

### General

Monitoring	Smoke, Ambient temperature
Indicator	Monitoring: red led flash(short flash once every 6 sec) Alarm: red led on
Alarm volume	80dB@3m
Overtemperature	57±2°C(typical)
Conformity	EN 14604
Mounting	Panel
Mounting height	12m max
Immunity	EN61000-6-3, EN 50130-4
Conformity standard	EN 14604
Degree of protection	IP20
Operating temperature(no icing, no condensation)	-10 to 65° C(14 to 149° F)
Storage temperature(no icing, no condensation)	-15 to 85° C(5 to 185° F)
Ambient humidity	95% max
Connection	Screw terminals
Wire diameter	0.4 - 1.5mm
Dimensions	65 x 65 x 39mm
Conformity	CE
Material	ABS/UL94-V0
Tightening torque	Max. 0.5Nm
Weight	approx 64g

### Output

Alarm outputs	Relay SPDT
Contact rating	24VDC, 1A(Resistive loads)
Response time	10 ms
Communication	Modbus-RTU RS485
Resolution@smoke	1PPM
Resolution@temperature	±0.2°C
Communication rate	2400, 4800, 9600, 19200bit/s
Communication address	0-99

### Supply

Power supply	12/24VDC (9-30VDC)
Current consumption	Monitoring 1mA@12VDC 5mA@24VDC Alarm is active 30mA@12VDC 35mA@24VDC



## Dimensions(mm)

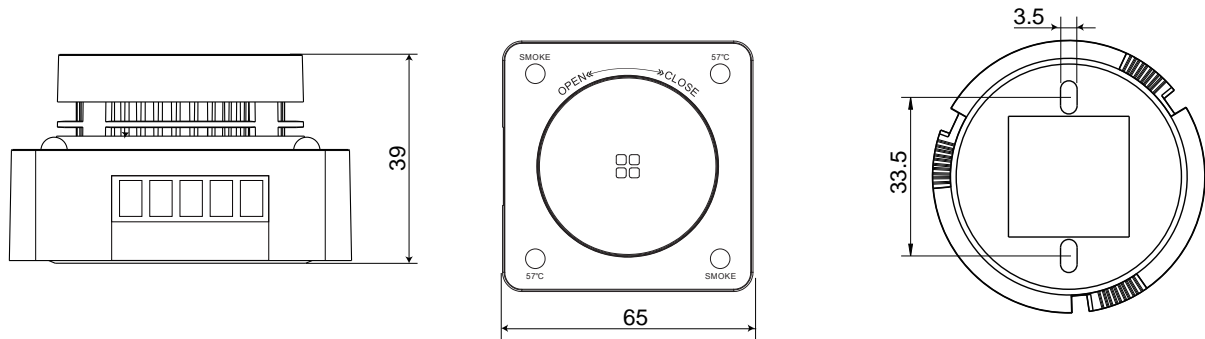

## Wiring diagram

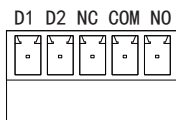

D1: Power supply  
 D2: Power supply  
 NC: Normal close  
 COM: Common  
 NO: Normal open

## Panel description

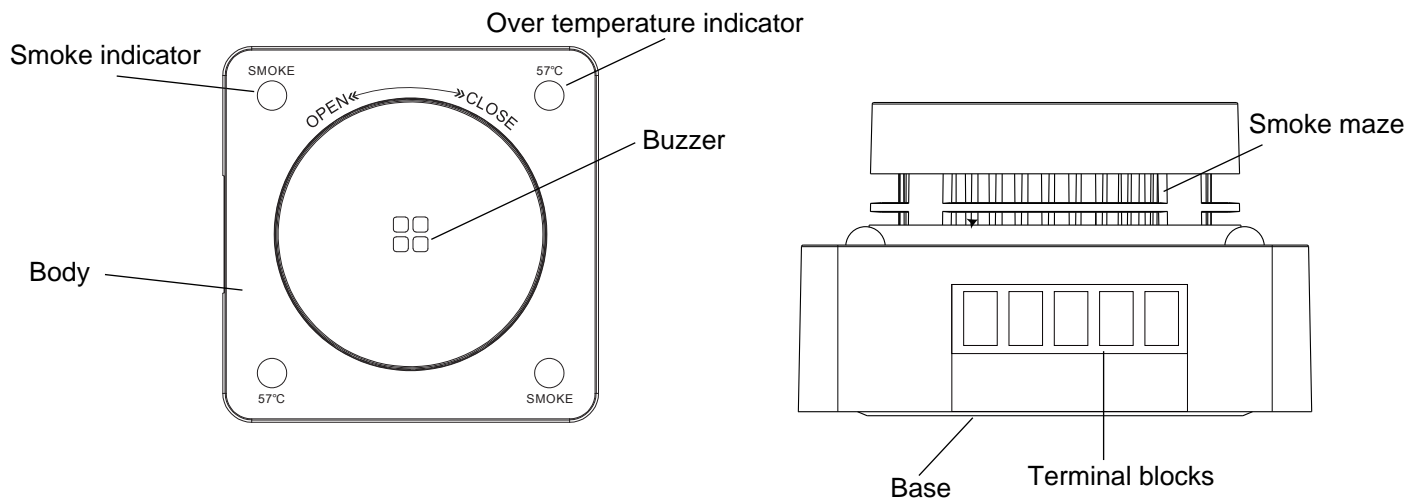

### Mounting

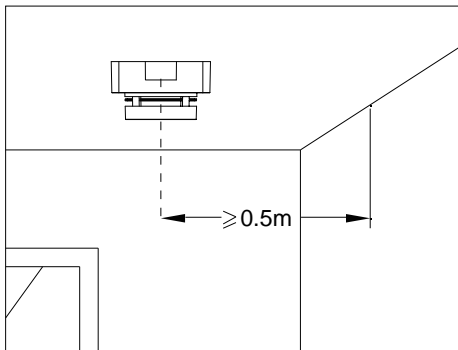
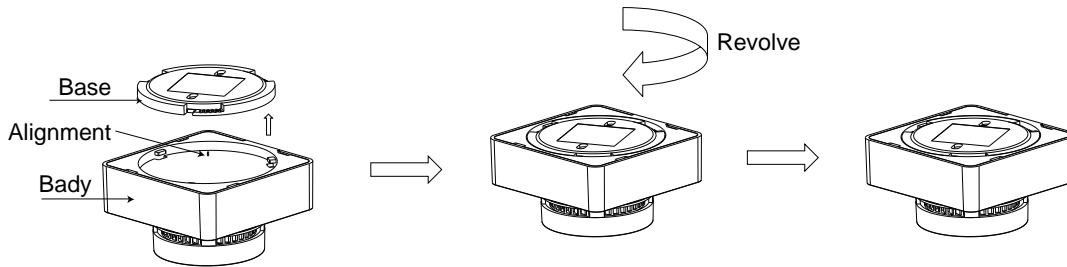

Cabinet side wall installation

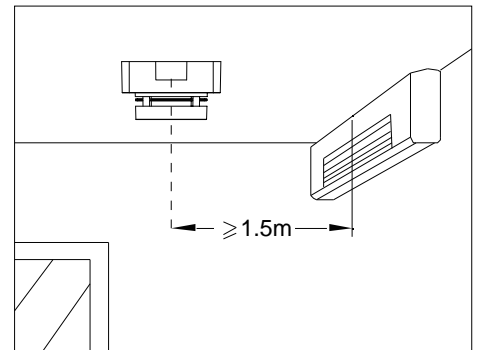
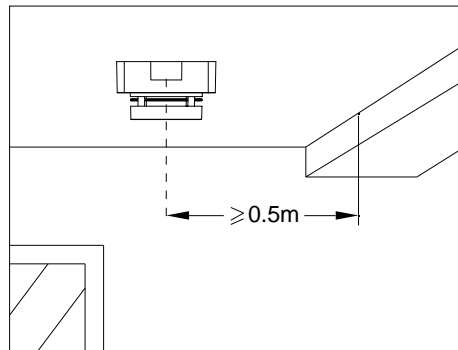

Distance from detector to air conditioner

#### Cabinet top

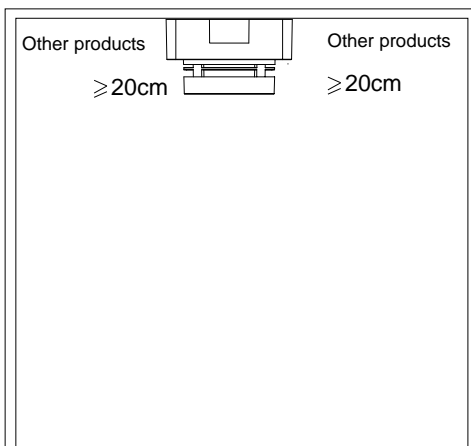

Cabinet top installation

#### Cabinet top

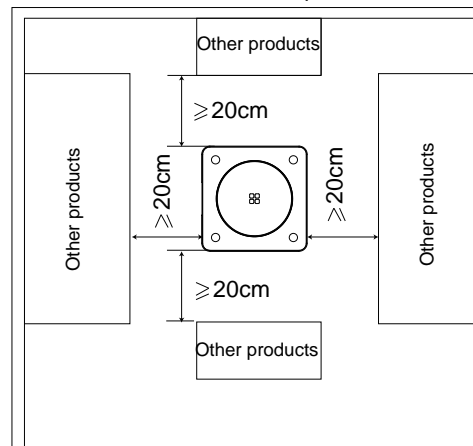

Cabinet side wall installation

Cabinet side wall

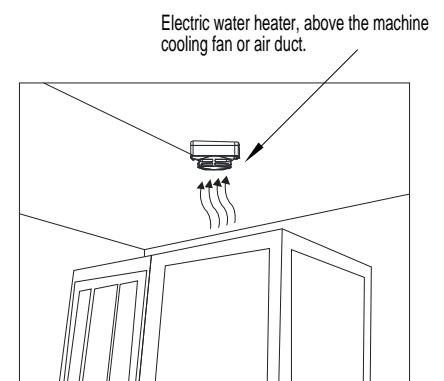

Incorrect installation



## Model description

